

M60/M62/M66 Simister Island Interchange

TR010064

**ENVIRONMENTAL STATEMENT FIGURES
CHAPTER 7 LANDSCAPE AND VISUAL
(FIGURE 7.7)**

APFP 5(2)(a)

Planning Act 2008

Infrastructure Planning (Applications: Prescribed
Forms and Procedure) Regulations 2009

VOLUME 6.2

December ~~November~~ 2024

Infrastructure Planning

Planning Act 2008

**The Infrastructure Planning
(Applications: Prescribed Forms and
Procedure) Regulations 2009**

M60/M62/M66 Simister Island Interchange
Development Consent Order 202[]

ENVIRONMENTAL STATEMENT FIGURES
CHAPTER 7 LANDSCAPE AND VISUAL (FIGURE 7.7)

Regulation Reference	5(2)(a)
Planning Inspectorate Scheme Reference	TR010064
Application Document Reference	TR010064/APP/6.2
Author	M60/M62/M66 Simister Island Interchange Costain Jacobs Partnership Project Team & National Highways

Version	Date	Status of Version
P02 <u>P03</u>	December <u>November</u> 2024	DEADLINE 3 UPDATE <u>DEADLINE 4 UPDATE</u>

CONTENTS

Environmental Statement Figures Chapter 7 Landscape and Visual (Figure 7.7)1

Environmental Statement Figures Chapter 7 Landscape and Visual (Figure 7.7)

~~1.1.1~~ This document contains ~~the following figure:~~

1.1.1 Figure 7.7 Photomontages which comprises a number of drawing sheets as detailed in the schedule below:

Table 1.1 Schedule of Figure 7.7 Photomontages drawing sheets

<u>Drawing Number</u>	<u>Drawing Title</u>	<u>Revision</u>
<u>HE548642-JAC-ELS-SII_MLT-VS-L-0201</u>	<u>FIGURE 7.7 PHOTOMONTAGES VIEWPOINT PM01 WINTER YEAR 1 (SHEET 1 OF 2)</u>	<u>P02</u>
<u>HE548642-JAC-ELS-SII_MLT-VS-L-0202</u>	<u>FIGURE 7.7 PHOTOMONTAGES VIEWPOINT PM01 SUMMER YEAR 1 (SHEET 2 OF 2)</u>	<u>P02</u>
<u>HE548642-JAC-ELS-SII_MLT-VS-L-0203</u>	<u>FIGURE 7.7 PHOTOMONTAGES VIEWPOINT PM02 WINTER YEAR 1 (SHEET 1 OF 2)</u>	<u>P01</u>
<u>HE548642-JAC-ELS-SII_MLT-VS-L-0204</u>	<u>FIGURE 7.7 PHOTOMONTAGES VIEWPOINT PM02 SUMMER YEAR 1 (SHEET 1 OF 2)</u>	<u>P02</u>
<u>HE548642-JAC-ELS-SII_MLT-VS-L-0205</u>	<u>FIGURE 7.7 PHOTOMONTAGES VIEWPOINT PM03 WINTER YEAR 1 (SHEET 1 OF 2)</u>	<u>P01</u>
<u>HE548642-JAC-ELS-SII_MLT-VS-L-0206</u>	<u>FIGURE 7.7 PHOTOMONTAGES VIEWPOINT PM03 SUMMER YEAR 1 (SHEET 1 OF 2)</u>	<u>P01</u>
<u>HE548642-JAC-ELS-SII_MLT-VS-L-0207</u>	<u>FIGURE 7.7 PHOTOMONTAGES VIEWPOINT PM04 WINTER YEAR 1 (SHEET 1 OF 2)</u>	<u>P01</u>
<u>HE548642-JAC-ELS-SII_MLT-VS-L-0208</u>	<u>FIGURE 7.7 PHOTOMONTAGES VIEWPOINT PM04 SUMMER YEAR 1 (SHEET 1 OF 2)</u>	<u>P02</u>
<u>HE548642-JAC-ELS-SII_MLT-VS-L-0209</u>	<u>FIGURE 7.7 PHOTOMONTAGES VIEWPOINT PM05 (VP27) WINTER YEAR 1 (SHEET 1 OF 1)</u>	<u>P01</u>

EXISTING - WINTER BASELINE



PHOTOMONTAGE - WINTER YEAR 1 OF OPERATION



VIEWPOINT PM01: View looking south west from Egypt Lane, footpath 9WHI and 46WHI, Simister to the Northern Loop, Pike Fold Viaduct and Bridge.

Visualisation type: Type 3 (in accordance with Landscape Institute Visual Representation of Development Proposals Technical Guidance Note 06/19)
 Date and time of photograph: 21/11/24 at 11.15
 Lighting conditions: Bright
 OS grid reference: 383149, 406635
 Viewpoint ground elevation: 94 m
 Projection: Cylindrical
 Sheet size: A1

Enlargement factor: 96% @ A1
 Camera type: Canon EOS 5D MARK III
 Camera lens size: 50 mm
 Camera height above ground level: 1.6 m
 Aperture: F/13
 ISO: 200
 Shutter speed: 1/200
 Horizontal field of view: 90°
 Vertical field of view: 27°
 Bearing to centre of panoramic: 223°

Rev	Rev. Date	Purpose of revision	Drawn	Checked	Rev'd	Apprv'd
P02	06/12/24	UPDATED FOR DEADLINE 4	RL	JP	JR	AP
P01	22/12/23	FOR DCO APPLICATION	RL	JP	JP	BB

NOTES:
 1. This photomontage is for illustrative purposes only and has been prepared in accordance with the methodology set out in Appendix 7.1 of the Environmental Statement Appendices [TR010064/APP/6.3].
 2. For larger plans showing all viewpoint locations, refer to Figure 7.5 of the Environmental Statement Figures [TR010064/APP/6.2].
 3. If using this photomontage to judge scale, view at A1 sheet size. The A1 sheet should be viewed centrally at a comfortable arm's length. If using this photomontage for landscape context, the figure may be viewed at A3 sheet size or viewed online.
 4. If viewing these figures online, images will be low-resolution and therefore should only be used for information purposes. High resolution versions of the figures can be obtained from National Highways on request if required.
 5. DEADLINE 4 UPDATE - viewpoint microsituated location in response to EX01 LV.1.6. Surveyed for winter season only due to Examination timeline.

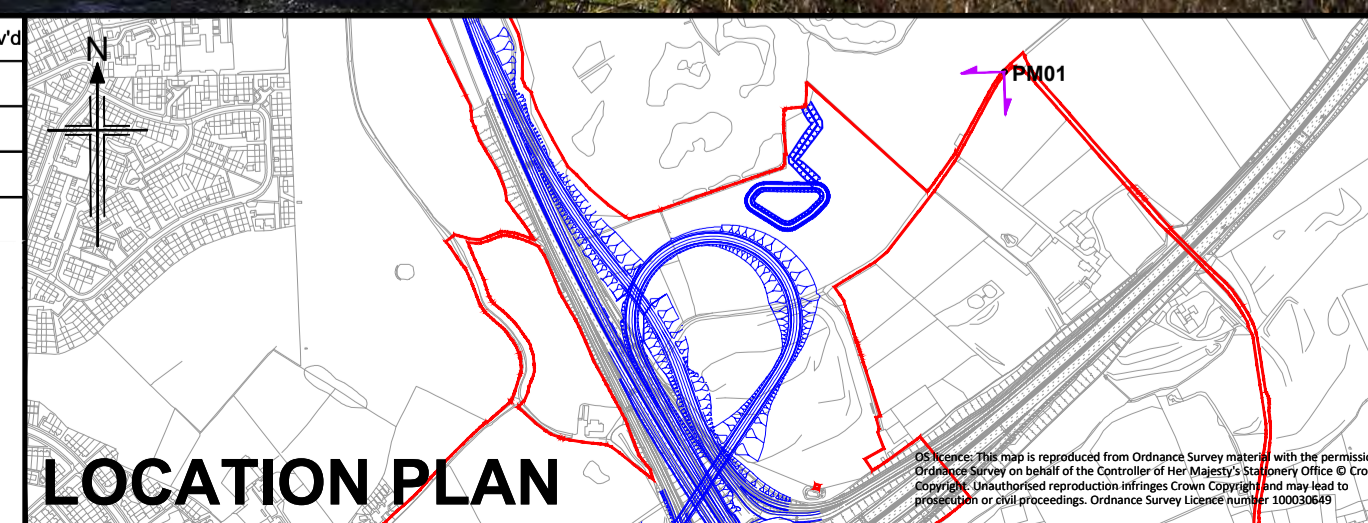

Development Consent Order Number TR010064	Development Consent Order Drawing Number TR010064/APP/6.2	Project M60/M62/M66 SIMISTER ISLAND INTERCHANGE
Regulation Regulation 5(2)(a)	Purpose of Issue DEADLINE 4 UPDATE	Drawing Title FIGURE 7.7 PHOTOMONTAGES VIEWPOINT PM01 WINTER YEAR 1 (SHEET 1 OF 2)
Scale at A1 (841x594mm) N/A@A1	Drawing Status S4	Jacobs No B36601F0
Client 	Client No HE548642	Rev P02
Drawing Number HE548642 - SII MLT	Originator JAC	Volume - ELS - -VS- L -0201

EXISTING - SUMMER BASELINE



PHOTOMONTAGE - SUMMER YEAR 15 OF OPERATION



VIEWPOINT PM01: View looking south west from Egypt Lane, footpath 9WHI and 46WHI, Simister to the Northern Loop, Pike Fold Viaduct and Bridge.

Visualisation type: Type 3 (in accordance with Landscape Institute Visual Representation of Development Proposals Technical Guidance Note 06/19)
 Date and time of photograph: 08/09/21 at 11.15
 Lighting conditions: Sunny
 OS grid reference: 383163 , 406638
 Viewpoint ground elevation: 91 m
 Projection: Cylindrical
 Sheet size: A1

Enlargement factor: 96% @ A1
 Camera type: Canon EOS 5D MARK III
 Camera lens size: 50 mm
 Camera height above ground level: 1.6 m
 Aperture: F/9
 ISO: 200
 Shutter speed: 1/800
 Horizontal field of view: 90°
 Vertical field of view: 27°
 Bearing to centre of panoramic: 223°

Rev	Rev. Date	Purpose of revision	Drawn	Checked	Rev'd	Apprv'd
P02	04/11/24	UPDATED FOR DEADLINE 3	RL	JP	JP	AP
P01	22/12/23	FOR DCO APPLICATION	RL	JP	JP	BB

NOTES:
 1. This photomontage is for illustrative purposes only and has been prepared in accordance with the methodology set out in Appendix 7.1 of the Environmental Statement Appendices [TR010064/APP/6.3]
 2. For larger plans showing all viewpoint locations, refer to Figure 7.5 of the Environmental Statement Figures [TR010064/APP/6.2]
 3. If using this photomontage to judge scale, view at A1 sheet size. The A1 sheet should be viewed centrally at a comfortable arm's length. If using this photomontage for landscape content, the figure may be viewed at A3 sheet size or viewed online.
 4. If viewing these figures online, images will be low-resolution and therefore should only be used for information purposes. High resolution versions of the figures can be obtained from National Highways on request if required.

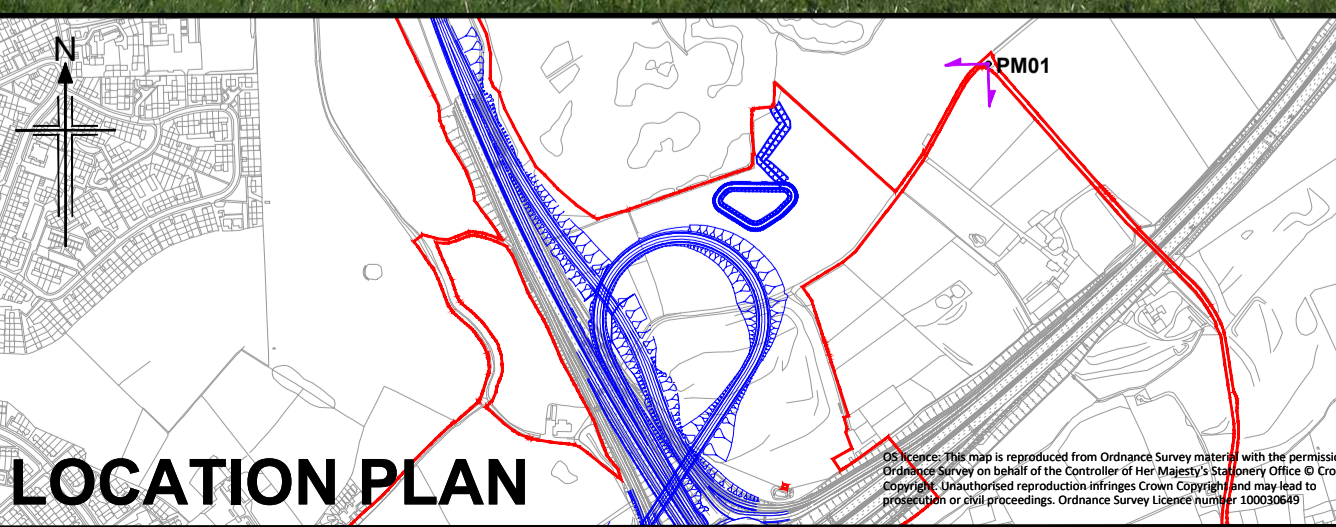

Development Consent Order Number TR010064	Development Consent Order Drawing Number TR010064/APP/6.2	Project M60/M62/M66 SIMISTER ISLAND INTERCHANGE
Regulation Regulation 5(2)(a)	Purpose of Issue DEADLINE 3 UPDATE	Drawing Title FIGURE 7.7 PHOTOMONTAGES VIEWPOINT PM01 SUMMER YEAR 15 (SHEET 2 OF 2)
Scale at A1 (841x594mm) N/A@A1	Client national highways	Jacobs No B36601F0
		Client No HE548642
		Rev P02
		Drawing Number HE548642 - SII MLT
		Originator JAC
		Volume - ELS -
		I Type Role Number -VS- L -0202

EXISTING - WINTER BASELINE



PHOTOMONTAGE - WINTER YEAR 1 OF OPERATION



VIEWPOINT PM02: View looking east from Marston Close in Whitefield to the Simister Pike Fold Viaduct and new embankment.

Visualisation type: Type 3 (in accordance with Landscape Institute Visual Representation of Development Proposals Technical Guidance Note 06/19)
 Date and time of photograph: 07/02/22 at 11:40
 Lighting conditions: Overcast
 OS grid reference: 382326, 405949
 Viewpoint ground elevation: 97 m
 Projection: Cylindrical
 Sheet size: A1

Enlargement factor: 96% @ A1
 Camera type: Canon EOS 5D MARK III
 Camera lens size: 50 mm
 Camera height above ground level: 1.6 m
 Aperture: F/8
 ISO: 200
 Shutter speed: 1/250
 Horizontal field of view: 90°
 Vertical field of view: 27°
 Bearing to centre of panoramic: 100°

Rev	Rev. Date	Purpose of revision	Drawn	Checked	Rev'd	Apprv'd
P01	22/12/23	FOR DCO APPLICATION	RL	JP	JP	BB

NOTES:
 1. This photomontage is for illustrative purposes only and has been prepared in accordance with the methodology set out in Appendix 7.1 of the Environmental Statement Appendices [TR010064/APP/6.3].
 2. For larger plans showing all viewpoint locations, refer to Figure 7.5 of the Environmental Statement Figures [TR010064/APP/6.2].
 3. If using this photomontage to judge scale, view at A1 sheet size. The A1 sheet should be viewed centrally at a comfortable arm's length. If using this photomontage for landscape context, the figure may be viewed at A3 sheet size or viewed online.
 4. If viewing these figures online, images will be low-resolution and therefore should only be used for information purposes. High resolution versions of the figures can be obtained from National Highways on request if required.

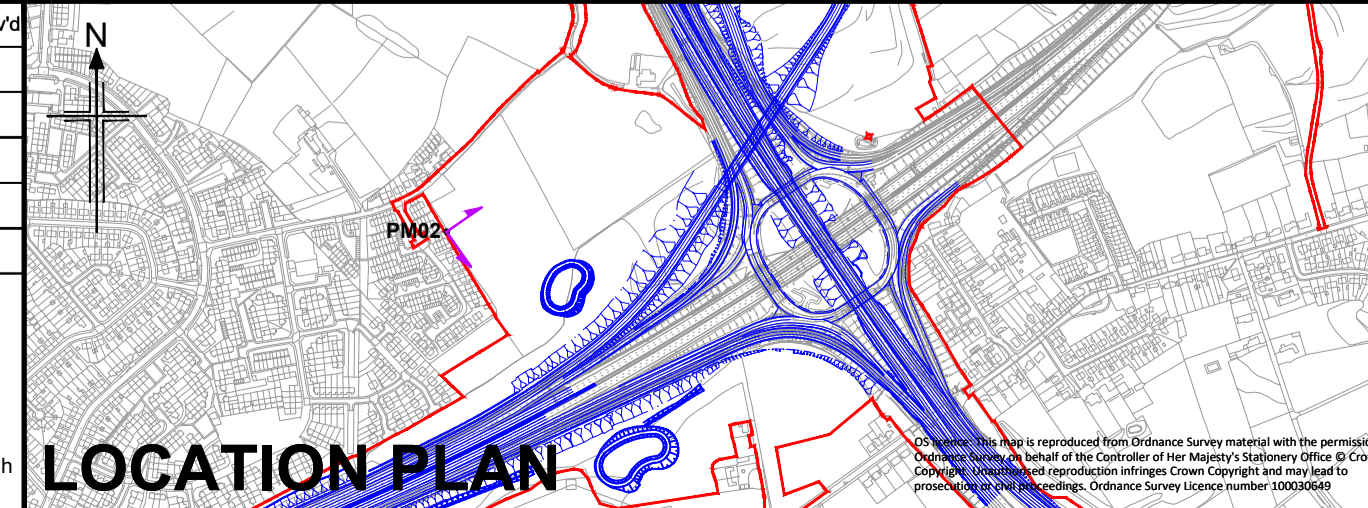

Development Consent Order Number TR010064	Development Consent Order Drawing Number TR010064/APP/6.2	Project M60/M62/M66 SIMISTER ISLAND INTERCHANGE
Regulation Regulation 5(2)(a)		Drawing Title FIGURE 7.7 PHOTOMONTAGES VIEWPOINT PM02 WINTER YEAR 1 (SHEET 1 OF 2)
Purpose of issue DCO APPLICATION	Drawing Status S4	Jacobs No B36601F0
Scale at A1 (841x594mm) N/A@A1	Client No HE548642	Rev P01
Client 	Drawing Number HE548642 - SII MLT	Originator JAC
		Volume - ELS -
		Type Role Number -VS- L -0203

EXISTING - SUMMER BASELINE



PHOTOMONTAGE - SUMMER YEAR 15 OF OPERATION



VIEWPOINT PM02: View looking east from Marston Close in Whitefield to the Simister Pike Fold Viaduct and new embankment.

Visualisation type: Type 3 (in accordance with Landscape Institute Visual Representation of Development Proposals Technical Guidance Note 06/19)
 Date and time of photograph: 08/09/21 at 16.32
 Lighting conditions: Sunny/Clear
 OS grid reference: 382336, 405953
 Viewpoint ground elevation: 97 m
 Projection: Cylindrical
 Sheet size: A1

Enlargement factor: 96% @ A1
 Camera type: Canon EOS 5D MARK III
 Camera lens size: 50 mm
 Camera height above ground level: 1.6 m
 Aperture: F/9
 ISO: 200
 Shutter speed: 1/320
 Horizontal field of view: 90°
 Vertical field of view: 27°
 Bearing to centre of panoramic: 100°

Rev	Rev. Date	Purpose of revision	Drawn	Checked	Rev'd	Apprv'd
P02	04/11/24	UPDATED FOR DEADLINE 3	RL	JP	JP	AP
P01	22/12/23	FOR DCO APPLICATION	RL	JP	JP	BB

NOTES:
 1. This photomontage is for illustrative purposes only and has been prepared in accordance with the methodology set out in Appendix 7.1 of the Environmental Statement Appendices [TR010064/APP/6.3].
 2. For larger plans showing all viewpoint locations, refer to Figure 7.5 of the Environmental Statement Figures [TR010064/APP/6.2].
 3. If using this photomontage to judge scale, view at A1 sheet size. The A1 sheet should be viewed centrally at a comfortable arm's length. If using this photomontage for landscape context, the figure may be viewed at A3 sheet size or viewed online.
 4. If viewing these figures online, images will be low-resolution and therefore should only be used for information purposes. High resolution versions of the figures can be obtained from National Highways on request if required.

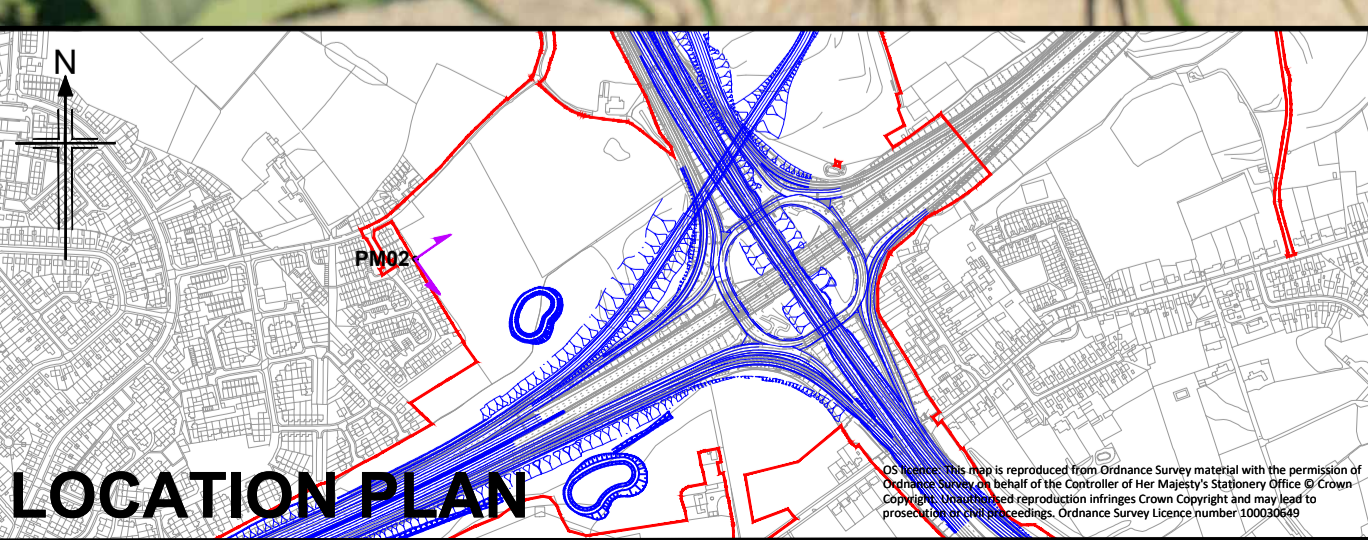

Development Consent Order Number TR010064	Development Consent Order Drawing Number TR010064/APP/6.2	Project M60/M62/M66 SIMISTER ISLAND INTERCHANGE
Regulation Regulation 5(2)(a)		Drawing Title FIGURE 7.7 PHOTOMONTAGES VIEWPOINT PM02 SUMMER YEAR 15 (SHEET 2 OF 2)
Purpose of Issue DEADLINE 3 UPDATE	Drawing Status S4	Jacobs No B36601F0
Scale at A1 (841x594mm) N/A@A1	Client 	Client No HE548642
Drawing Number HE548642 - SII MLT		Originator JAC
Location SII MLT		Volume - ELS - I Type Role Number -VS- L -0204

EXISTING - WINTER BASELINE



PHOTOMONTAGE - WINTER YEAR 1 OF OPERATION



VIEWPOINT PM03: View looking south from Derwent Avenue towards the M60 on the existing embankment.

Visualisation type: Type 3 (in accordance with Landscape Institute Visual Representation of Development Proposals Technical Guidance Note 06/19)
 Date and time of photograph: 01/12/22 at 11:40
 Lighting conditions: Cloudy
 OS grid reference: 382105, 405664
 Viewpoint ground elevation: 98 m
 Projection: Cylindrical
 Sheet size: A1

Enlargement factor: 96% @ A1
 Camera type: Canon EOS 6D MARK II
 Camera lens size: 50 mm
 Camera height above ground level: 1.6 m
 Aperture: F/7.1
 ISO: 200
 Shutter speed: 1/40
 Horizontal field of view: 90°
 Vertical field of view: 27°
 Bearing to centre of panoramic: 180°

Rev	Rev. Date	Purpose of revision	Drawn	Checked	Rev'd	Apprv'd
P01	22/12/23	FOR DCO APPLICATION	RL	JP	JP	BB

NOTES:
 1. This photomontage is for illustrative purposes only and has been prepared in accordance with the methodology set out in Appendix 7.1 of the Environmental Statement Appendices [TR010064/APP/6.3].
 2. For larger plans showing all viewpoint locations, refer to Figure 7.5 of the Environmental Statement Figures [TR010064/APP/6.2].
 3. If using this photomontage to judge scale, view at A1 sheet size. The A1 sheet should be viewed centrally at a comfortable arm's length. If using this photomontage for landscape context, the figure may be viewed at A3 sheet size or viewed online.
 4. If viewing these figures online, images will be low-resolution and therefore should only be used for information purposes. High resolution versions of the figures can be obtained from National Highways on request if required.

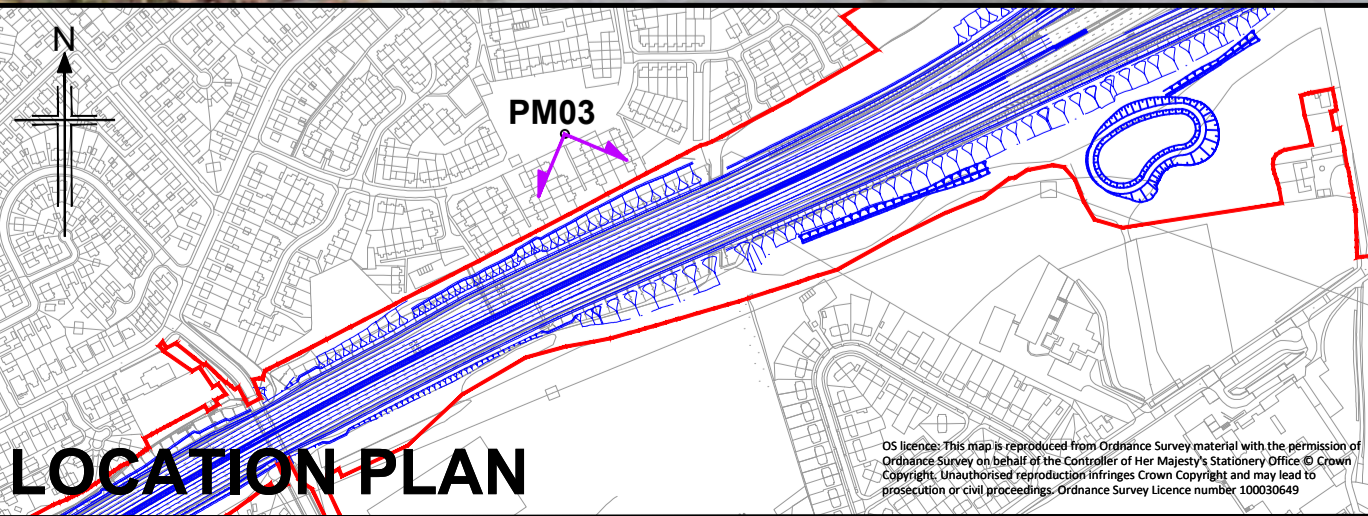

Development Consent Order Number TR010064	Development Consent Order Drawing Number TR010064/APP/6.2	Project M60/M62/M66 SIMISTER ISLAND INTERCHANGE
Regulation Regulation 5(2)(a)	Drawing Status S4	Drawing Title FIGURE 7.7 PHOTOMONTAGES VIEWPOINT PM03 WINTER YEAR 1 (SHEET 1 OF 2)
Purpose of issue DCO APPLICATION	Scale at A1 (841x594mm) N/A@A1	Jacobs No B36601F0
Client national highways	Client No HE548642	Rev P01
Drawing Number HE548642 - SII MLT	Originator JAC	Volume ELS - VS - L -0205

EXISTING - SUMMER BASELINE



PHOTOMONTAGE - SUMMER YEAR 15 OF OPERATION



VIEWPOINT PM03: View looking south from Derwent Avenue towards the M60 on the existing embankment.

Visualisation type: Type 3 (in accordance with Landscape Institute Visual Representation of Development Proposals Technical Guidance Note 06/19)
 Date and time of photograph: 05/10/22 at 14:33
 Lighting conditions: Sunny
 OS grid reference: 382099, 405655
 Viewpoint ground elevation: 98 m
 Projection: Cylindrical
 Sheet size: A1

Enlargement factor: 96% @ A1
 Camera type: Canon EOS 6D MARK II
 Camera lens size: 50 mm
 Camera height above ground level: 1.6 m
 Aperture: F/7.1
 ISO: 200
 Shutter speed: 1/125
 Horizontal field of view: 90°
 Vertical field of view: 27°
 Bearing to centre of panoramic: 180°

Rev	Rev. Date	Purpose of revision	Drawn	Checked	Rev'd	Apprv'd
P01	22/12/23	FOR DCO APPLICATION	RL	JP	JP	BB

NOTES:
 1. This photomontage is for illustrative purposes only and has been prepared in accordance with the methodology set out in Appendix 7.1 of the Environmental Statement Appendices [TR010064/APP/6.3].
 2. For larger plans showing all viewpoint locations, refer to Figure 7.5 of the Environmental Statement Figures [TR010064/APP/6.2].
 3. If using this photomontage to judge scale, view at A1 sheet size. The A1 sheet should be viewed centrally at a comfortable arm's length. If using this photomontage for landscape context, the figure may be viewed at A3 sheet size or viewed online.
 4. If viewing these figures online, images will be low-resolution and therefore should only be used for information purposes. High resolution versions of the figures can be obtained from National Highways on request if required.

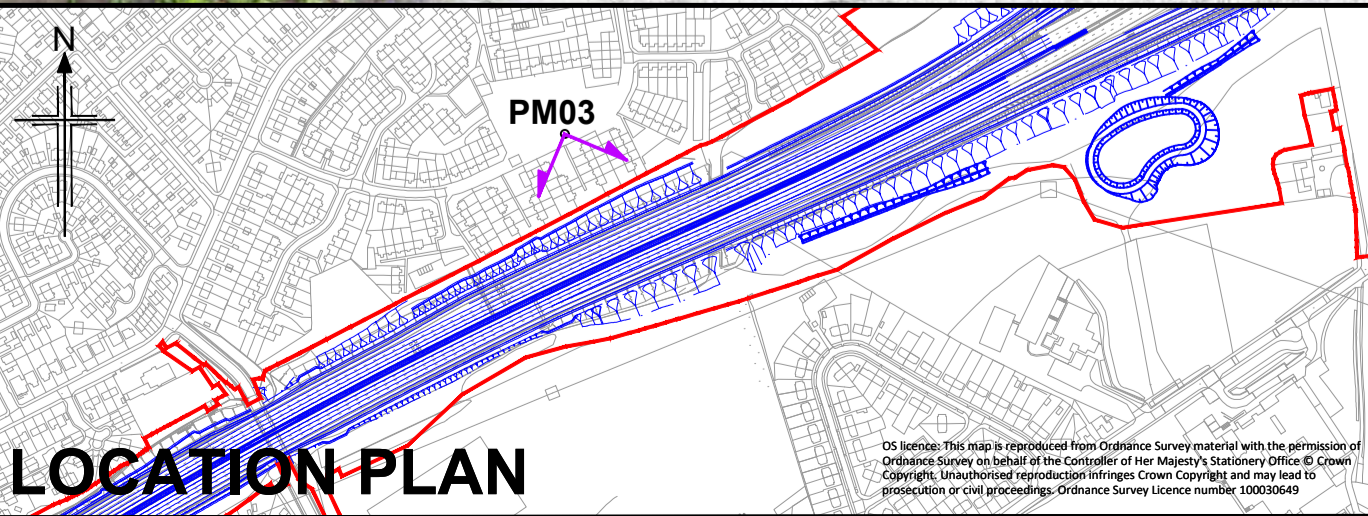

Development Consent Order Number TR010064	Development Consent Order Drawing Number TR010064/APP/6.2	Project M60/M62/M66 SIMISTER ISLAND INTERCHANGE
Regulation Regulation 5(2)(a)	Drawing Title FIGURE 7.7 PHOTOMONTAGES VIEWPOINT PM03 SUMMER YEAR 15 (SHEET 2 OF 2)	Scale at A1 (841x594mm) N/A@A1
Purpose of issue DCO APPLICATION	Drawing Status S4	Jacobus No B36601F0
Client national highways	Originator JAC	Volume - ELS -
	Location SII MLT	Rev P01
		Type Role Number -VS- L -0206

EXISTING - WINTER BASELINE



PHOTOMONTAGE - WINTER YEAR 1 OF OPERATION



VIEWPOINT PM04: View looking north-east from Heywood Road near Parrenthorn High School to the new M60 west bound on-slip.

Visualisation type: Type 3 (in accordance with Landscape Institute Visual Representation of Development Proposals Technical Guidance Note 06/19)
 Date and time of photograph: 25/03/21 at 14.00
 Lighting conditions: Partially cloudy
 OS grid reference: 382611, 405459
 Viewpoint ground elevation: 103 m
 Projection: Cylindrical
 Sheet size: A1

Enlargement factor: 96% @ A1
 Camera type: Canon EOS 5D MARK III
 Camera lens size: 50 mm
 Camera height above ground level: 1.6 m
 Aperture: F/7.1
 ISO: 400
 Shutter speed: 1/2500
 Horizontal field of view: 90°
 Vertical field of view: 27°
 Bearing to centre of panoramic: 40°

Rev	Rev. Date	Purpose of revision	Drawn	Checked	Rev'd	Apprv'd
P01	22/12/23	FOR DCO APPLICATION	RL	JP	JP	BB

NOTES:
 1. This photomontage is for illustrative purposes only and has been prepared in accordance with the methodology set out in Appendix 7.1 of the Environmental Statement Appendices [TR010064/APP/6.3].
 2. For larger plans showing all viewpoint locations, refer to Figure 7.5 of the Environmental Statement Figures [TR010064/APP/6.2].
 3. If using this photomontage to judge scale, view at A1 sheet size. The A1 sheet should be viewed centrally at a comfortable arm's length. If using this photomontage for landscape context, the figure may be viewed at A3 sheet size or viewed online.
 4. If viewing these figures online, images will be low-resolution and therefore should only be used for information purposes. High resolution versions of the figures can be obtained from National Highways on request if required.

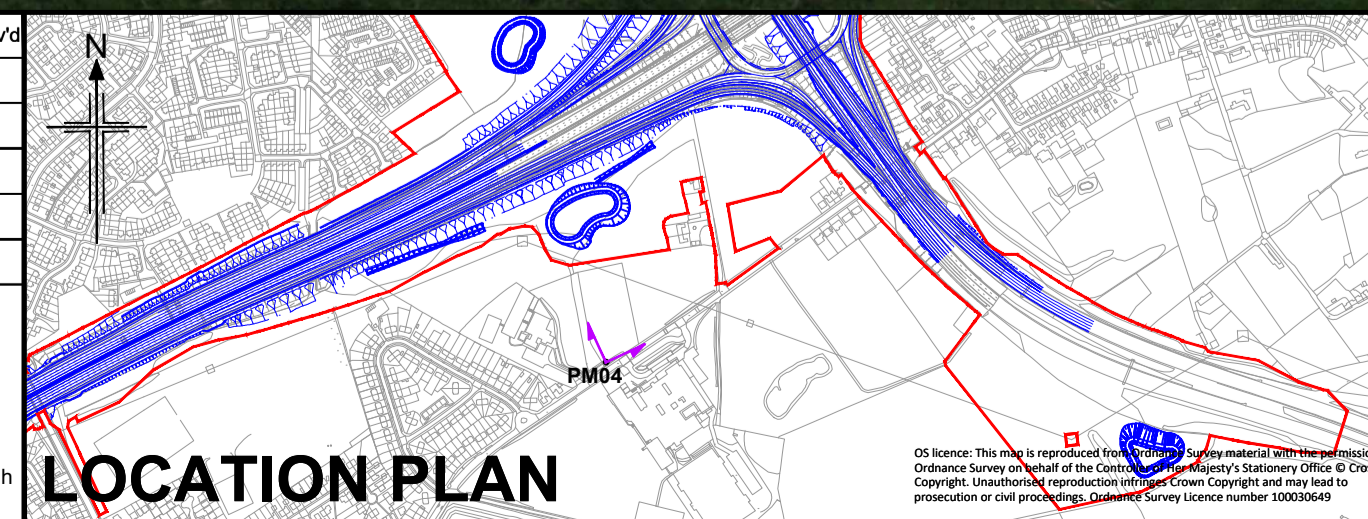

Development Consent Order Number TR010064	Development Consent Order Drawing Number TR010064/APP/6.2	Project M60/M62/M66 SIMISTER ISLAND INTERCHANGE
Regulation Regulation 5(2)(a)	Purpose of issue DCO APPLICATION	Drawing Title FIGURE 7.7 PHOTOMONTAGES VIEWPOINT PM04 WINTER YEAR 1 (SHEET 1 OF 2)
Scale at A1 (841x594mm) N/A@A1	Client national highways	Jacobs No B36601F0
		Client No HE548642
		Rev P01
		Drawing Number HE548642 - SII MLT
		Originator JAC
		Volume - ELS -
		Type Role Number -VS- L -0207

EXISTING - SUMMER BASELINE



PHOTOMONTAGE - SUMMER YEAR 15 OF OPERATION



VIEWPOINT PM04: View looking north-east from Heywood Road near Parrenthorn High School to the new M60 west bound on-slip.

Visualisation type: Type 3 (in accordance with Landscape Institute Visual Representation of Development Proposals Technical Guidance Note 06/19)
 Date and time of photograph: 08/09/21 at 14:11
 Lighting conditions: Partially cloudy
 OS grid reference: 382612, 405452
 Viewpoint ground elevation: 103 m
 Projection: Cylindrical
 Sheet size: A1

Enlargement factor: 96% @ A1
 Camera type: Canon EOS 5D MARK III
 Camera lens size: 50 mm
 Camera height above ground level: 1.6 m
 Aperture: F/9
 ISO: 200
 Shutter speed: 1/800
 Horizontal field of view: 90°
 Vertical field of view: 27°
 Bearing to centre of panoramic: 40°

Rev	Rev. Date	Purpose of revision	Drawn	Checked	Rev'd	Apprv'd
P02	04/11/24	UPDATED FOR DEADLINE 3	RL	JP	JP	AP
P01	22/12/23	FOR DCO APPLICATION	RL	JP	JP	BB

NOTES:
 1. This photomontage is for illustrative purposes only and has been prepared in accordance with the methodology set out in Appendix 7.1 of the Environmental Statement Appendices [TR010064/APP/6.3].
 2. For larger plans showing all viewpoint locations, refer to Figure 7.5 of the Environmental Statement Figures [TR010064/APP/6.2].
 3. If using this photomontage to judge scale, view at A1 sheet size. The A1 sheet should be viewed centrally at a comfortable arm's length. If using this photomontage for landscape content, the figure may be viewed at A3 sheet size or viewed online.
 4. If viewing these figures online, images will be low-resolution and therefore should only be used for information purposes. High resolution versions of the figures can be obtained from National Highways on request if required.

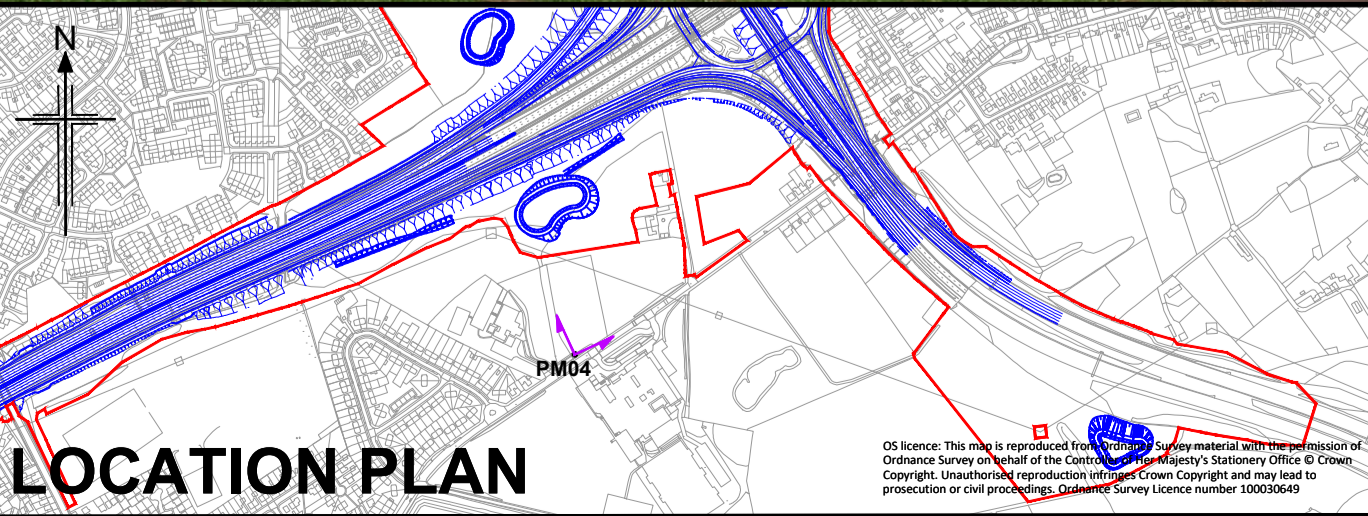

Development Consent Order Number TR010064	Development Consent Order Drawing Number TR010064/APP/6.2	Project M60/M62/M66 SIMISTER ISLAND INTERCHANGE
Regulation Regulation 5(2)(a)		Drawing Title FIGURE 7.7 PHOTOMONTAGES VIEWPOINT PM04 SUMMER YEAR 15 (SHEET 2 OF 2)
Purpose of Issue DEADLINE 3 UPDATE	Drawing Status S4	Jacobs No B36601F0
Scale at A1 (841x594mm) N/A@A1	Client No HE548642	Rev P02
Client national highways	Drawing Number HE548642 - SII MLT	Originator JAC
		Volume - ELS -
		Type Role Number -VS- L -0208

EXISTING - WINTER BASELINE



PHOTOMONTAGE - WINTER YEAR 1 OF OPERATION



VIEWPOINT PM05 (VP27): View looking west from the corner of Warwick Avenue and Barnard Avenue to the M60 boundary fence.

Visualisation type: Type 3 (in accordance with Landscape Institute Visual Representation of Development Proposals Technical Guidance Note 06/19)
 Date and time of photograph: 21/11/24 at 10.30
 Lighting conditions: Bright
 OS grid reference: 381666 , 405231
 Viewpoint ground elevation: 100 m
 Projection: Cylindrical
 Sheet size: A1

Enlargement factor: 96% @ A1
 Camera type: Canon EOS 5D MARK III
 Camera lens size: 50 mm
 Camera height above ground level: 1.6 m
 Aperture: F/13
 ISO: 320
 Shutter speed: 1/125
 Horizontal field of view: 90°
 Vertical field of view: 27°
 Bearing to centre of panoramic: 270°

Rev	Rev. Date	Purpose of revision	Drawn	Checked	Rev'd	Apprv'd
P01	06/12/24	DEADLINE 4 SUBMISSION	RL	JP	JR	AP

NOTES:

- This photomontage is for illustrative purposes only and has been prepared in accordance with the methodology set out in Appendix 7.1 of the Environmental Statement Appendices [TR010064/APP/6.3].
- For larger plans showing all viewpoint locations, refer to Figure 7.5 of the Environmental Statement Figures [TR010064/APP/6.2].
- If using this photomontage for judge scale, view at A1 sheet size. The A1 sheet should be viewed centrally at a comfortable arm's length. If using this photomontage for landscape context, the figure may be viewed at A3 sheet size or viewed online.
- If viewing these figures online, images will be low-resolution and therefore should only be used for information purposes. High resolution versions of the figures can be obtained from National Highways on request if required.
- DEADLINE 4 SUBMISSION: new photomontage added in response to ExQ1 LV.1.5 to reflect impact on properties. No vegetation or structural removal proposed as part of permanent or temporary works in this location. Images reflect scheme as completed in Winter Year 1 of opening.

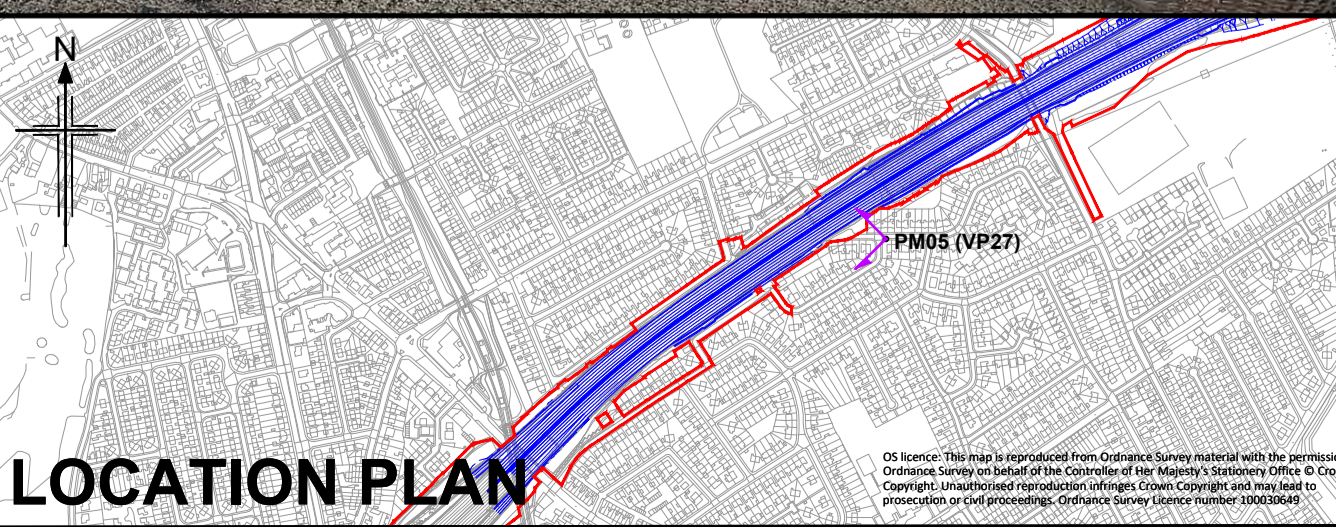

Development Consent Order Number TR010064	Development Consent Order Drawing Number TR010064/APP/6.2	Project M60/M62/M66 SIMISTER ISLAND INTERCHANGE
Regulation Regulation 5(2)(a)	Drawing Title FIGURE 7.7 PHOTOMONTAGES VIEWPOINT PM05 (VP27) WINTER YEAR 1 (SHEET 1 OF 1)	Regulation DEADLINE 4 SUBMISSION
Purpose of issue DEADLINE 4 SUBMISSION	Drawing Status S4	Scale at A1 (841x594mm) N/A@A1
Client national highways	Jacobs No B36601F0	Client No HE548642
Drawing Number HE548642 - SII MLT	Originator JAC	Volume ELS - VS - L -0209
		Rev P01